

Criterion 4 – Infrastructure and Learning Resources (100)

4.1- Physical Facilities (30)

4.1.1

The Institution has adequate infrastructure and physical facilities for teaching learning viz classrooms, laboratories computing equipment etc. (Marks-05)

In the biganing stage our college was started in a social building at Bakarupara having some small rooms. After 14 year in 2003 the college has been shifted to kumharpara area. The college campus is in 25 akad in which the building has been constructed. The college building having 9 Classrooms, 1 Library, 1 Geography Lab, 1 Botany Lab, 1 Zoology Lab. 1 Physics Lab, 1 Separate Common room for girls, 1staff room as well as 1Principal room and 1Office room. After shifting of college to it's own building it's started to increase the students day by day. The teaching learning facility is increasing in the college and some additional facility is also added. One seminar hall is also available in our college for organizing seminar or for the arrangement of any meeting program organized by the NCC/NSS or any other department of the college.

In the year 2018 the college has got the additional two flour building by the RUSA fund. The new building having 8 big rooms in which 4 rooms are classrooms and 3 rooms are well equipped with smart class and one room is used for computer Lab with internet facility and 1 room is used for Chemistry Lab. The college is also having its own two set public address system and one projector in the Seminar Hall. There are 37 computers is the college. The college is always trying to increase the physical facility for the students day by day. There are separate toilet rooms for boys and girls students in both buildings of the college. There are 10 staff quarters behind the college building which includes F type (01), G type (03), H type (04), I type (02) A guest room is also available in the college to provide accommodation facility for the outsider. A cycle stand for students and vehicles stand for college staff is also there. IQAC room for NAAC coordinator and staff room for all the college staff is available there, where staff can sit in there free period.

The college has a beautiful garden in front of the college building in which different types of flower plants has been planted. In our college campus different types of trees like fruits and other medicinal plants has been also planted. Trees help us to keep our-self fresh and healthy. It also help us to provide fresh air and make the college building attractive and beautiful. The whole college campus is surrounded by a boundary wall.

S.N.	Room No.	Room Name	Size
1	1	IQAC Room	5.40x4.80
2	2	Principal Room	5.40x4.80
3	3	Office Room	5.70x8.60
4	4	Class Room	5.70x8.60
5	5	Chemistry Department	5.70x8.60
6	6	Hindi Department + NSS	5.70x8.60
7	7	Commerce Department	5.70x8.60
8	8	Hall	15.00x8.00m
9	9	Boys Toilet	4.20x5.80
10	10	Exam Control Room	8.60x5.70
11	11	Girls Common Room	8.60x5.70
12	12	Girls Toilet	4.20x5.80
13	13	Class Room	5.70x8.60
14	14	Class Room	5.70x8.60
15	15	Class Room	5.70x8.60
16	16	Economics Department + NCC	5.70x8.60
17	17	Staff Room	
18	18	Library	17.80x5.80m
19	19	Class Room	5.8x8.7m
20	20	Botany Department + Lab	5.8x8.70
21	21	Zoology Department + Lab	5.8x8.70
22	22	Boys Toilet	4.20x5.80
23	23	Physics Department + Lab	8.80x5.80
24	24	Class Room	8.80x5.80
25	25	Girls Toilet	4.20x5.80
26	26	Class Room	5.80x4.30
27	27	Class Room	5.80x8.70
28	28	Class Room	5.80x8.70
29	29	Geography Department +Lab	6.50x9.00
30	30	Girls Toilet RUSA	8mx5m
31	31	Class Room RUSA	8.00x10.50m
32	32	Class Room RUSA + Computer Lab	8.00x10.50m
33	33	Class Room	8.00x10.50m
34	34	Chemistry Lab RUSA	8.00x10.50m
35	35	Boys Toilet RUSA	8.0mx4.0m
36	36	Girls Toilet RUSA	8mx5m
37	37	Class Room RUSA	8.00x10.50m
38	38	Class Room RUSA	8.00x10.50m
39	39	Class Room RUSA	8.00x10.50m
40	40	Class Room RUSA	8.00x10.50m
41	41	Boys Toilet RUSA	8mx5m

Principal
 Government Swami Atmarand P.G.
 Government Post Graduate College
 Narayanpur, Chhattisgarh

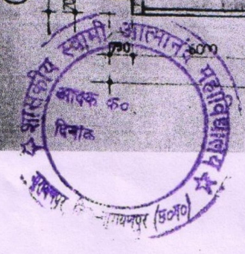
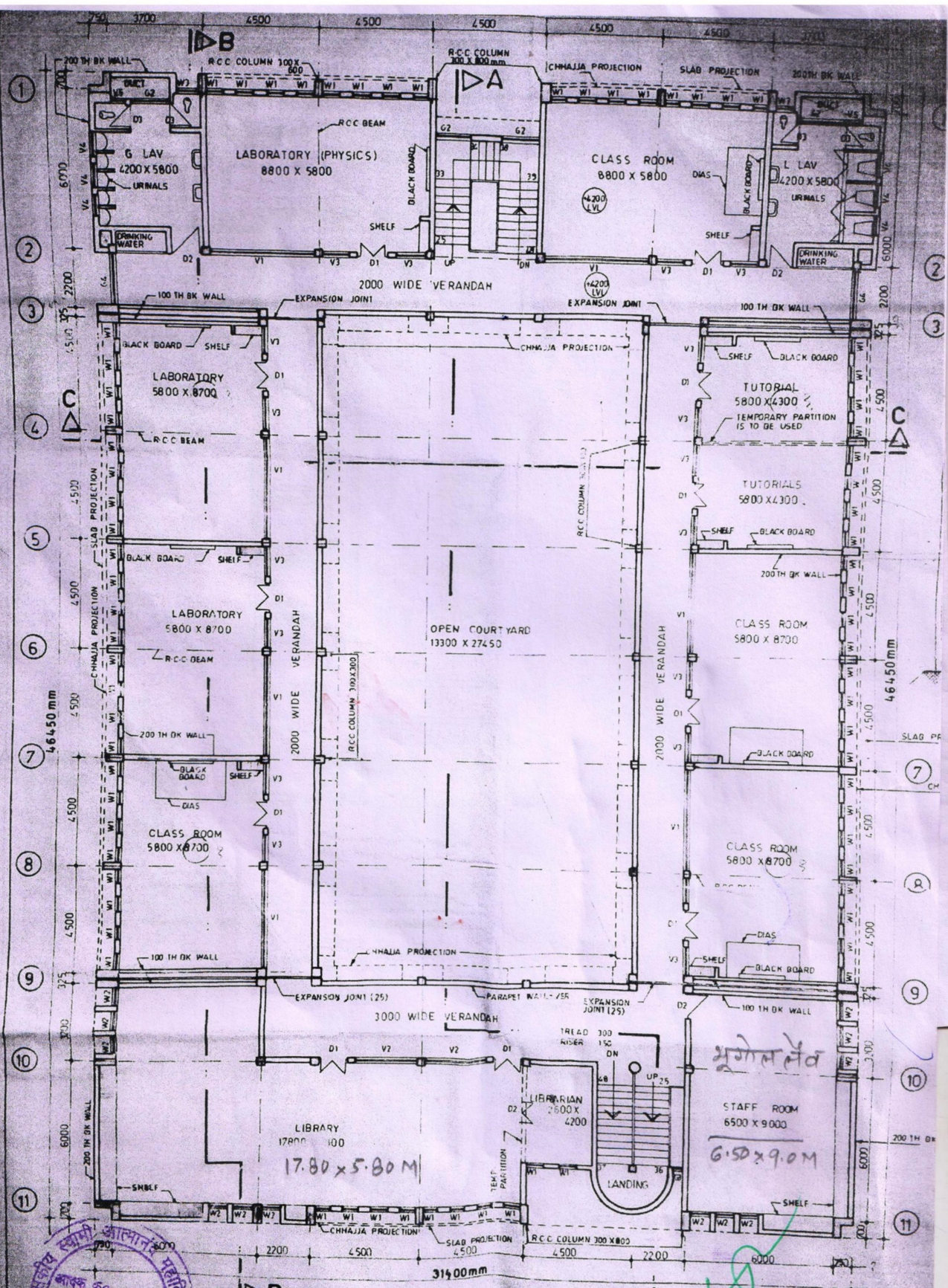

PRINCIPAL
 Government Post Graduate College
 Narayanpur, Dist. - Narayanpur
 Elhattisgarh

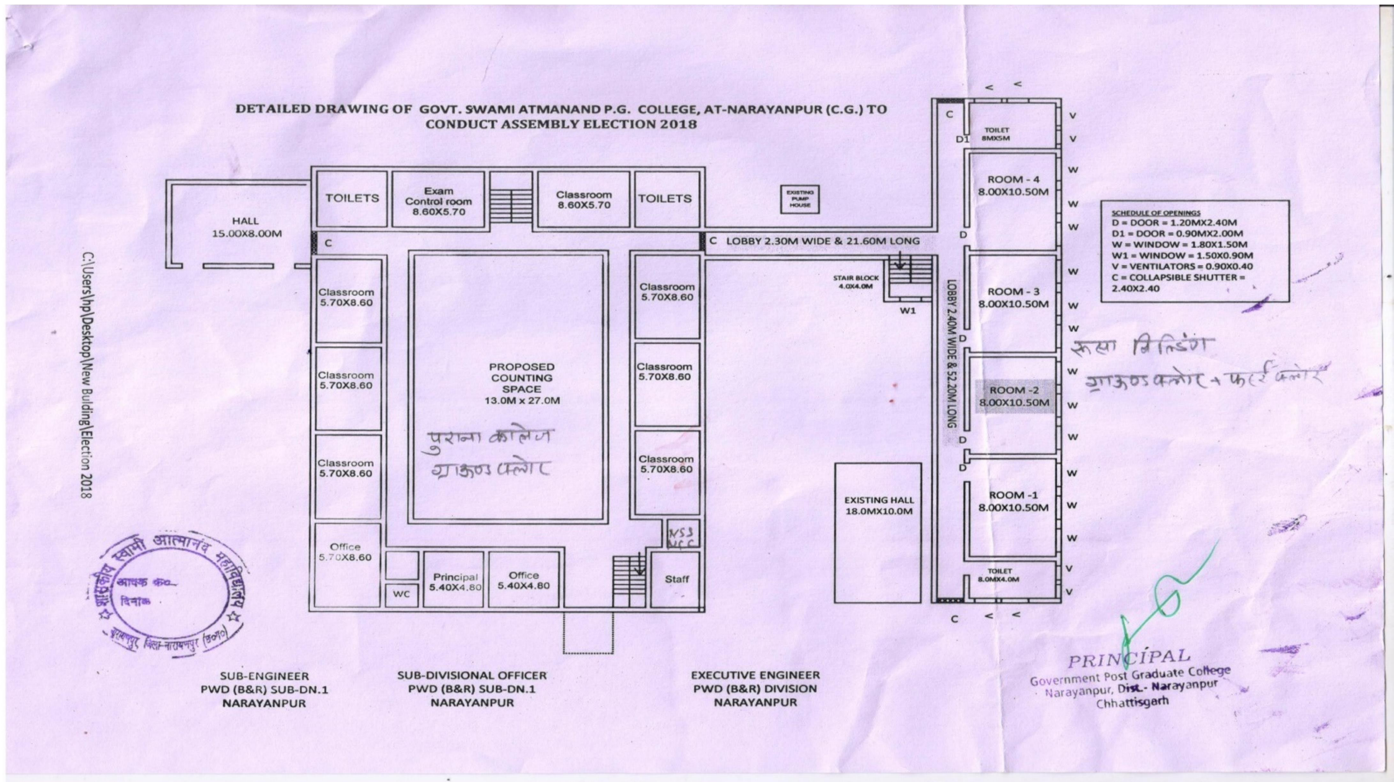

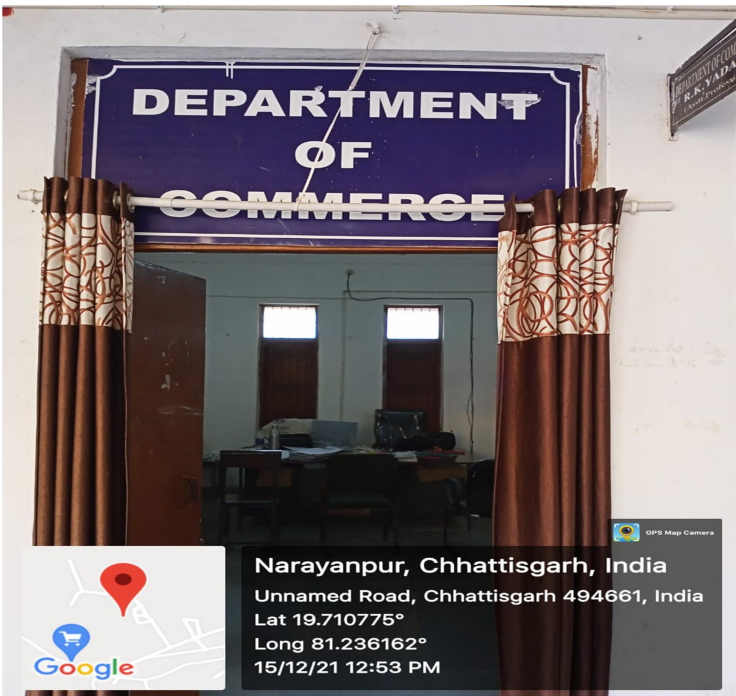



Narayanpur, Chhattisgarh, India
Unnamed Road, Chhattisgarh 494661, India
Lat 19.710698°
Long 81.23608°
15/12/21 12:54 PM



Narayanpur, Chhattisgarh, India
Unnamed Road, Chhattisgarh 494661, India
Lat 19.710648°
Long 81.236043°
15/12/21 12:54 PM



Narayanpur, Chhattisgarh, India
Unnamed Road, Chhattisgarh 494661, India
Lat 19.71081°
Long 81.235925°
15/12/21 12:54 PM



Narayanpur, Chhattisgarh, India
Unnamed Road, Chhattisgarh 494661, India
Lat 19.710832°
Long 81.235956°
15/12/21 12:54 PM



Narayanpur, Chhattisgarh, India
Unnamed Road, Chhattisgarh 494661, India
Lat 19.710864°
Long 81.235984°
15/12/21 12:55 PM

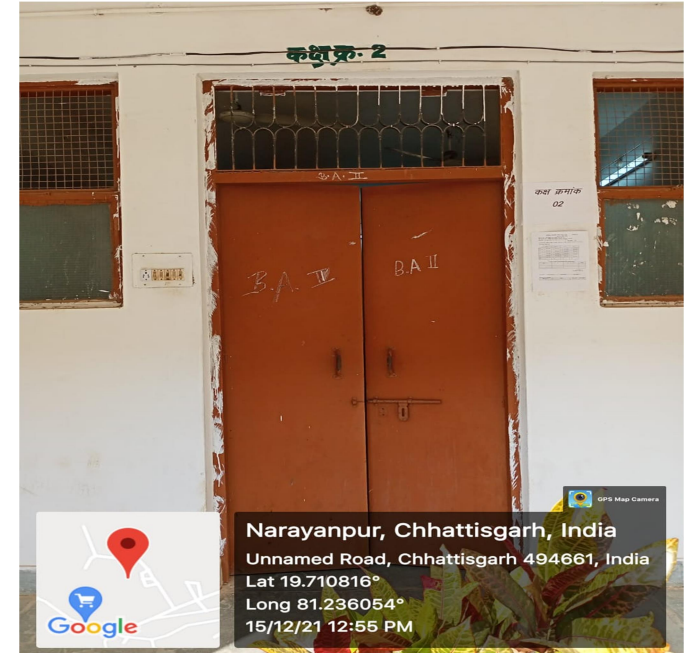

Narayanpur, Chhattisgarh, India
Unnamed Road, Chhattisgarh 494661, India
Lat 19.710816°
Long 81.236054°
15/12/21 12:55 PM



Narayanpur, Chhattisgarh, India
Unnamed Road, Chhattisgarh 494661, India
Lat 19.710876°
Long 81.236232°
15/12/21 12:56 PM



Narayanpur, Chhattisgarh, India
Unnamed Road, Chhattisgarh 494661, India
Lat 19.710855°
Long 81.236283°
15/12/21 12:56 PM



Narayanpur, Chhattisgarh, India
Unnamed Road, Chhattisgarh 494661, India
Lat 19.710826°
Long 81.236142°
15/12/21 12:57 PM



Narayanpur, Chhattisgarh, India
Unnamed Road, Chhattisgarh 494661, India
Lat 19.710877°
Long 81.236335°
15/12/21 01:07 PM



Narayanpur, Chhattisgarh, India
Unnamed Road, Chhattisgarh 494661, India
Lat 19.710861°
Long 81.236373°
15/12/21 01:08 PM



Narayanpur, Chhattisgarh, India
Unnamed Road, Chhattisgarh 494661, India
Lat 19.710828°
Long 81.236317°
15/12/21 01:06 PM



Narayanpur, Chhattisgarh, India
Unnamed Road, Chhattisgarh 494661, India
Lat 19.710745°
Long 81.236138°
15/12/21 01:05 PM



Narayanpur, Chhattisgarh, India
Unnamed Road, Chhattisgarh 494661, India
Lat 19.710797°
Long 81.236109°
15/12/21 01:04 PM



Narayanpur, Chhattisgarh, India
Unnamed Road, Chhattisgarh 494661, India
Lat 19.710722°
Long 81.236121°
15/12/21 01:05 PM



Narayanpur, Chhattisgarh, India
Unnamed Road, Chhattisgarh 494661, India
Lat 19.710835°
Long 81.236032°
15/12/21 01:04 PM



Narayanpur, Chhattisgarh, India
Unnamed Road, Chhattisgarh 494661, India
Lat 19.710838°
Long 81.236009°
15/12/21 01:04 PM

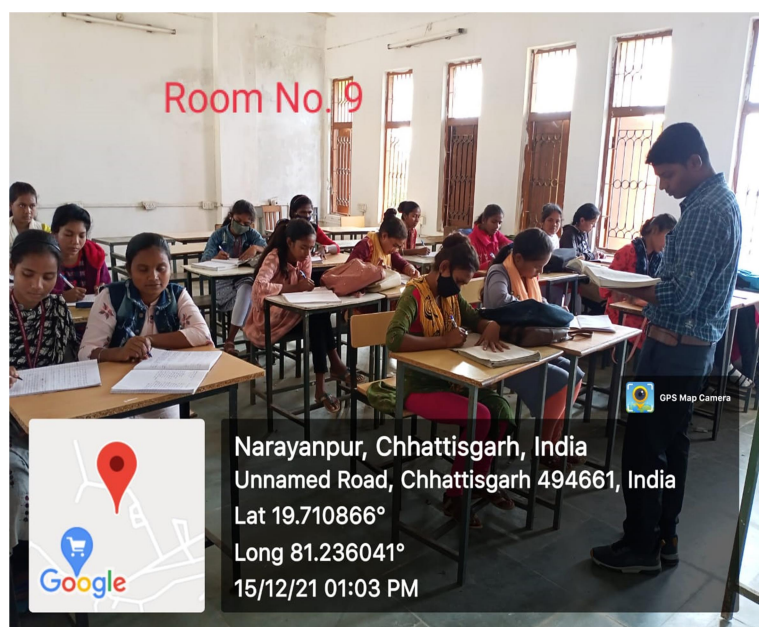

Narayanpur, Chhattisgarh, India
Unnamed Road, Chhattisgarh 494661, India
Lat 19.710866°
Long 81.236041°
15/12/21 01:03 PM



Girls Toilet Second Floor

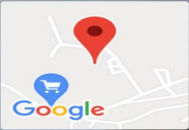

Narayanpur, Chhattisgarh, India
Unnamed Road, Chhattisgarh 494661, India
Lat 19.710879°
Long 81.236074°
15/12/21 01:02 PM

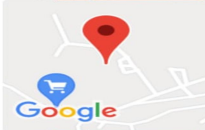

Narayanpur, Chhattisgarh, India
Unnamed Road, Chhattisgarh 494661, India
Lat 19.71086°
Long 81.236097°
15/12/21 01:02 PM



M.A. Economics Class Room

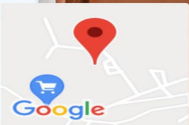

Narayanpur, Chhattisgarh, India
Unnamed Road, Chhattisgarh 494661, India
Lat 19.710903°
Long 81.236165°
15/12/21 01:01 PM



Geography Class Room (PG)

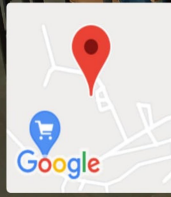

Narayanpur, Chhattisgarh, India
Unnamed Road, Chhattisgarh 494661, India
Lat 19.710896°
Long 81.236266°
15/12/21 01:00 PM



DEPARTMENT OF GEOGARAPHY

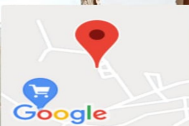

Narayanpur, Chhattisgarh, India
Unnamed Road, Chhattisgarh 494661, India
Lat 19.710899°
Long 81.236358°
15/12/21 12:59 PM



Girls Toilet RUSA



Narayanpur, Chhattisgarh, India
P66P+8FV, Narayanpur, Chhattisgarh 494661, India
Lat 19.71073°
Long 81.236304°
25/01/22 02:32 PM

